



Make your gutters virtually maintenance-free...Affordably!

The GutterDrainer system is an all season plastic channel placed along the bottom of the gutter. The water flows underneath into the channel while debris is blocked out. The flow is rushed to the outlet, preventing gutter overflow.

Some debris may accumulate, but the wind can blow it off the smooth plastic surfaces, and the water will always drain.

With GutterDrainer, cleaning is not necessary. GutterDrainer blocks out snow, absorbs heat from the sun, and keeps the channel open.

- Moderately priced
- Easy installation
- Works on all roof types
- Installs in 5" and 6" gutters
- 10-Year Replacement guarantee
- Minimizes gutter ice build-up and ice dam formation

Save time, and stay safe with GutterDrainer!

GutterDrainer[™]

It Absolutely Keeps The Water Flowing[™]



GutterDrainer[®]

It Absolutely Keeps The Water Flowing[™]

Before installation go to our website www.GutterDrainer.com - OR - Scan the QR code for directions.

CAUTION: Wear safety glasses. Ladders and roof walking may be required. Use *extreme caution* while climbing around power lines.

NOTES: Be sure your gutters and downspouts are clean. Gutter Drainer[®] installs best at 40° F and above & can be easily cut with scissors. Gutter Drainer[®] must be installed in the entire gutter length(s).

TOOLS REQUIRED:

- Standard Scissors
- Masking Tape
- Tape Measure
- Sheet Metal Screws (for corners, not provided)

METHOD:

STEP 1: Unroll Gutter Drainer[®] and cut into 10' to 15' lengths.

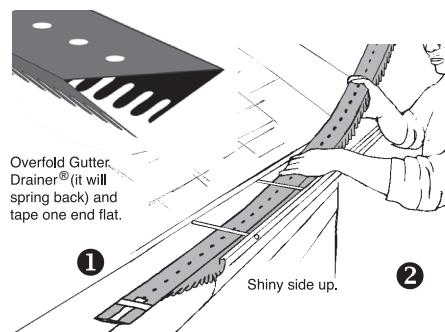

STEP 2: Prefold Gutter Drainer[®] at creases to form a channel. Overfold and tape one end flat as per ①. *Make sure shiny side is out!*

STEP 3: Slide into gutter covering the downspouts. Be sure to seat Gutter Drainer[®] to the bottom of the gutter with *shiny side up* as shown in ②.

STEP 4: Expansion joints are required every 10' to a maximum of 15'. Overlap Gutter Drainer[®] 6" to provide expansion joint as shown in ③. **Do not put Hold Down Clips in the overlap region!**

NOTE: Allow clearance from both ends of gutter of approx. 1/2".

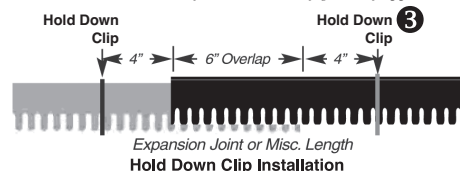

STEP 5: CORNERS (if required). Cut two 12" lengths of Gutter Drainer[®] and notch ends as show in ④. Overlap and secure with sheet metal screw (not provided). Place corner assembly in gutter **under** ends of Gutter Drainer[®] ⑤, allowing 6" overlap for expansion. **Do not put Hold Down Clips in the overlap region!**

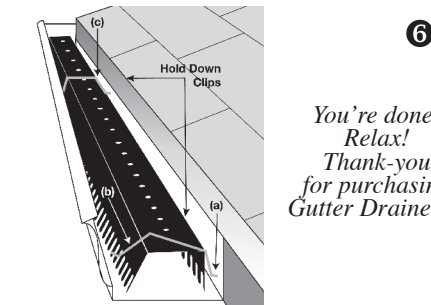
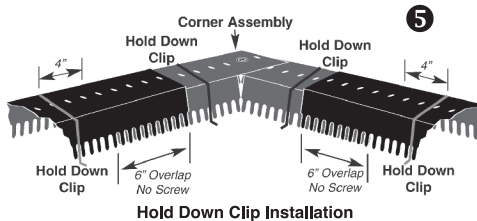
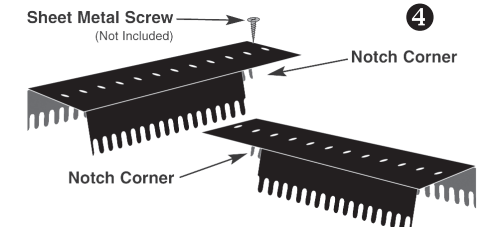

*You're done;
Relax!
Thank-you
for purchasing
Gutter Drainer[®]!*

STEP 6: Place (provided) Hold Down Clips starting 2" from the ends and approx. at 2' intervals and 4" from all overlaps. See ③ & ⑤. It works best to insert clips all the way down the back of gutter, (6a). Then compress and place other end in the bottom of front of gutter, (6b). Hold Down Clips properly installed should fit over Gutter Drainer[®] as in (6c).



Scan this QR CODE with your mobile device to see how easy it is to install GutterDrainer.



Distributed by Hansen Global, Inc.
P: 1.877.793.5213 F: 1.920.793.8127
hansenglobalinc.com